

Scottronic Sales and Service Ltd.
Innovators in Electronics.

 P.O. Box 495, Kerikeri.
 Bay of Islands. New Zealand 0470.
 Web site: www.scottronic.com

 Phone: (64) 9 407-5581
 Fax: (64) 9 407-5582
 Email: keith@scottronic.com

MEMORY CARD

Description: This is a tiny plug-in card, which stores job transaction details. Depending on how it is configured, it can store **all** transactions or just **non-cash**



transactions. It has a capacity to store up to 256 job records, and can also be used to carry a list of "hot cards" to the meter.

Every transaction recorded contains the following:

- Date/Time stamp at start-fare
- Shift Km. recording at start-fare
- Tariff selected at start-fare
- Time duration of trip at end-of-fare
- Km. recorded for the trip
- Fare displayed at end-of-trip
- Extras displayed at end-of-trip
- Maximum speed reached during the trip

If the fare recorded was a card transaction then card details (as read by the swipe reader or input by the driver) will also be stored for the transaction.

The meter can be configured to operate **only** if a memory card is fitted. If no card is present, the message "Waiting for Mem. Module" appears on the screen when the For Hire mode is selected.

Local Government subsidy schemes such as "Total Mobility" have recently been redefined in several cities: T.M. passengers are to be issued with plastic cards (with magnetic strip). The taxi-meter trip details must be recorded with the card details, fully automatically.

In conjunction with the swipe reader, the Novax 2020 meter's card handling facility and the memory card, all the requirements of the scheme are met. All "special" card transactions (Total Mobility) being saved to the memory card. The meter calculates the subsidy amount and displays it along with the amount payable by the passenger.

In operation, simply swipe the customer's card through the swipe reader when the meter is displaying the "Total Fare". If the customer's card is a valid "Total Mobility" card, the subsidy will be applied and the screen will clearly display the amount payable. The transaction is stored when the meter is cleared.

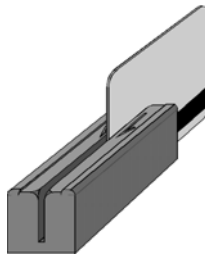

There is provision within the memory card to store a list of "Hot Cards". The meter will check each card number swiped or entered against this list. Should a "Hot Card" be encountered the message "Card Rejected" will be displayed.

Memory Card Records. At predetermined intervals, stored transactions will need to be read from the memory card and uploaded to the ARC for reimbursement. Larger organisations will require the memory cards to be removed from the meter and taken to the office to be read. Smaller operators may prefer to read the card direct from their meter, into a portable computer which can be plugged into the meter's serial port. Special software is available to manage this procedure.

Novax TaxiTerminal. This unit is basically a Novax 2020 with specific software to perform the management tasks of the memory card. Included with it are 230v power pack, a desk stand and a computer cable. Although reading the memory card is its primary function, it has a number of other purposes supporting the memory card and taximeter/swipe reader operation.

There are a few cautions associated with this equipment;

The contents of the card can be erased entirely, along with your records if procedures are not followed carefully.

The memory card can be configured for other tasks which are not applicable to your needs. Altering the configuration could render your cards useless for the normal application.

Generally, it will not be necessary to operate any buttons on the TaxiTerminal. The memory card can be uploaded to the pc, and the Memory card reset from within the software running on the pc.

If you have unread records on your card, avoid operating any buttons on the TaxiTerminal with the memory card inserted. The result could be lost data!

ARC Total Mobility Support Software.

This utility has been written specifically for supporting the Novax taxi-meter equipment for use with ARC Total Mobility cards.

Its primary function is to periodically read the stored records from the memory cards and append them to a data file, the memory cards can then be reset and re-used. When all cards for the period have been read, the data file is then used to generate a batch file in the format required by ARC. This batch file can then be emailed or copied to floppy disk. ARC will then process the file and reimburse the service provider's account with the appropriate subsidy amount. In addition to the batch file a summary of each memory card read and the total for the batch file is stored for your own records, and for use by third party software for invoicing purposes etc.

A secondary function of the Novax software is to maintain the "Hot list" written to the memory card. Periodically, ARC may issue a current list of "Hot cards". This should be copied to the folder "Blacklist". Upon selecting "Send Hot list" this file will be opened and the list of card numbers (up to a maximum of 48) will be copied to the memory card. Where the taximeter is used, rather than the TaxiTerminal the connection time should be kept to a minimum. Once accessed by the pc in this manner the meter is in a vulnerable state, unexpected incoming data could have undesirable effects on internal meter data.

Disclaimer

Every care has been taken to ensure safe and reliable operation of this equipment, however Scottronic Sales and Service Ltd cannot accept responsibility for lost data, or unexpected operation.